

ProLine 15/17 Set-Up Sheet

STEP 1 - ATTACH TRIPOD MOUNTING PLATE

The ProLine 15/17's patent pending mounting system allows the use of any size/weight camera. This mounting system allows the tripod mounting plate to be attached to either the upper rail or lower rail of the teleprompter. For heavier cameras mounting the tripod plate to the upper rail has the added benefit of lowering the center of gravity for improved tripod head operation. In addition, the tripod mounting plate can slide anywhere along the rails for precise balancing.



For lighter cameras the tripod mounting plate is attached to the lower rail.



For heavier cameras the tripod mounting plate is attached to the upper rail.



Tripod plate slides into channel on either upper or lower rail.

Loosen thumbscrews and lift up retaining plate on back of upper rail to slide on tripod mounting plate.



Slide tripod mounting plate front to back to balance teleprompter



Tighten screws to secure tripod plate. Screws can be tightened with a coin or screwdriver.



The tripod mounting plate offers both 1/4" and 3/8" industry standard mounting holes. Attach this plate to your tripod's quick release plate.

STEP 2 - LCD INSTALL

Slide the LCD monitor onto the lower rail and tighten the thumbscrew.

The LCD can be adjusted fore/aft by loosening the thumbscrew. To remove the LCD unscrew the thumbscrew all the way and slide the LCD off the rail.

Note: The thumbscrew has a stop to keep it from coming out all the way.

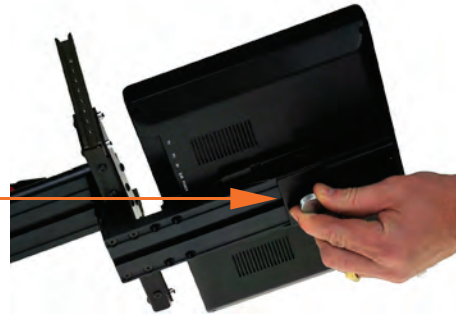

MIRROR ASSEMBLY REMOVAL

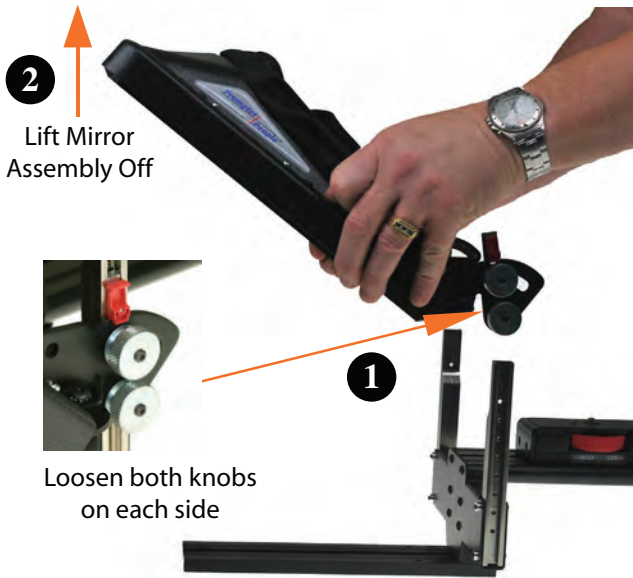

MIRROR ASSEMBLY ATTACHMENT

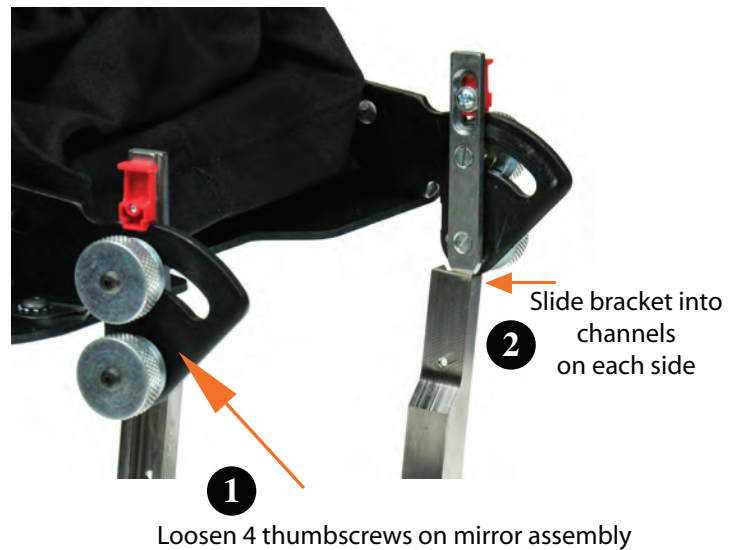

ADJUSTING MIRROR ASSEMBLY

The ProLine 15/17's patent pending mirror assembly offers both height and angle adjustment. The mirror assembly can also be folded flat for easy, safe transport. The mirror assembly offers an infinitely adjustable angle and locks at the closed and standard 45 degree positions. The mirror assembly can also be easily removed for more compact transport.

OPENING MIRROR ASSEMBLY

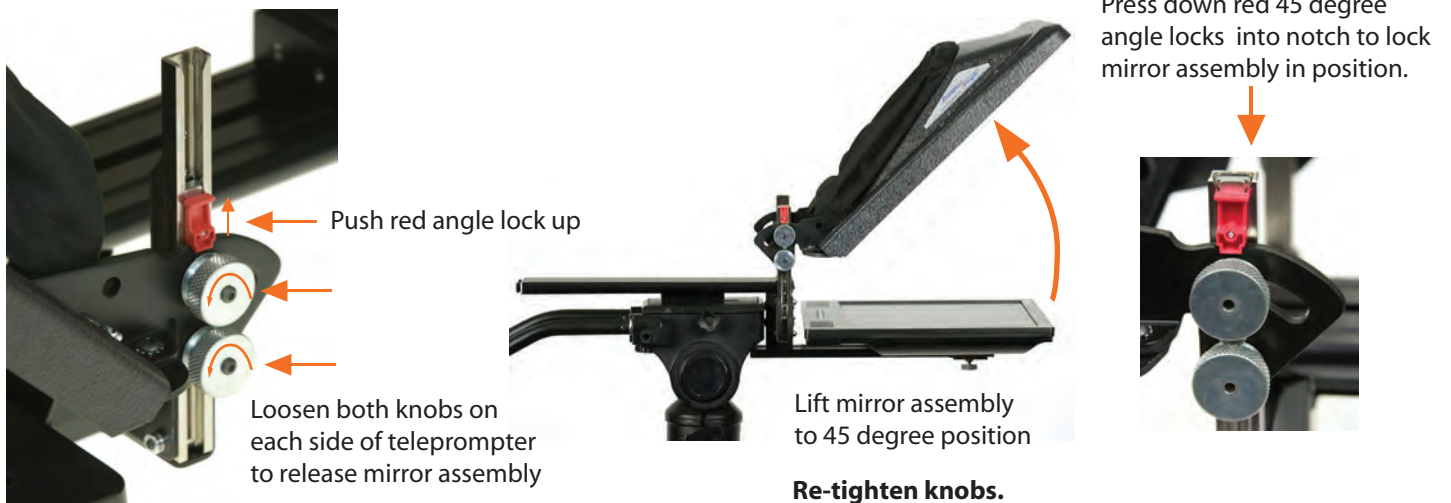

STEP 3 - ATTACH CAMERA TO TELEPROMPTER

The ProLine 15/17 offers multiple methods for attaching your video camera. Larger cameras attach directly to the camera mounting block. Smaller cameras mount on the included dual height camera riser that attaches to the camera mounting block. The dual height camera riser also allows cameras with short or flush mounted lenses to get closer to the teleprompter mirror for optimum performance.

The ProLine 15/17 has a height scale on the mirror assembly. To use this scale measure the center of the camera lens from the bottom of the camera.

MEASURE LENS HEIGHT

Measure from the bottom of the camera to the center of the lens. This is your camera lens height. Write down this number. You will use this number to adjust the mirror height in a later step.



PLACE CAMERA ON SLED

Place camera on camera mounting block.



The spring loaded pin locks into camera hole to keep camera from rotating. Rotate camera until this locks in place.

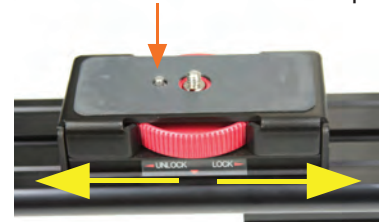

Turn the camera knob to secure camera. Loosen slightly to adjust camera position. When camera is in position turn knob to lock into place. Do not over tighten.

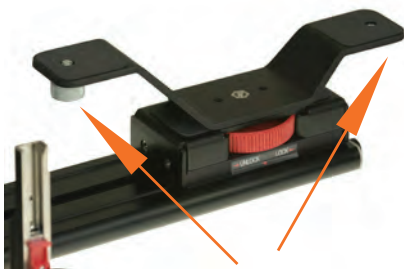

The camera thumbscrew can be removed from one end and attached to the other side.

USING DUAL HEIGHT RISER

The dual height camera riser is used with smaller cameras. To attach simply place riser on camera mounting block and tighten the camera block knob. Loosen slightly to adjust camera position.

NOTE: Full sized cameras do not require dual height riser.



Example of palm camcorder with riser block.

STEP 4 - CAMERA/LCD POSITION ADJUSTMENT

The ProLine 15/17's top mounted camera block makes fore/aft camera positioning a fast, tool-free procedure. Remove the lens shade on your camera so that the lens can get as close to the glass as possible. Then simply turn the large red, knurled knob to tighten or release the camera for easy adjustment. The cloth lens shade wraps around the lens to keep light from entering from the rear. The 10.4" LCD can be positioned fore/aft by loosening its thumbscrew. The LCD can be quickly removed for safe, compact transport. The mirror assembly can also be quickly removed for safe and compact transport.



Turn knob to left to unlock and to the right to lock. Remove the cameras lens shade. Position camera lens within 1/2" from glass.



Once camera is positioned place lens shade around lens. Tighten lens shade with draw string.

ADJUSTING MIRROR HEIGHT



Raise the mirror assembly so that the camera lens is in the middle of the mirror.

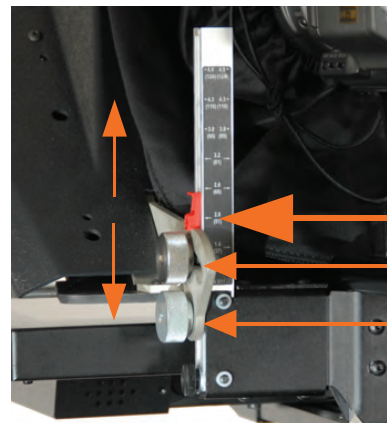

To use height scale position the top of the bracket to the point on the scale that corresponds to your cameras lens height. Measure the lens height from the bottom of the camera.

Tighten both knobs on each side to lock mirror height in place



ADJUSTING MIRROR ANGLE

To adjust mirror assembly to an angle other than 45 degrees do the following

1. Lift the angle lock on both sides.
2. *Slightly* loosen the four thumb screws,
3. Adjust angle and tighten knobs to lock

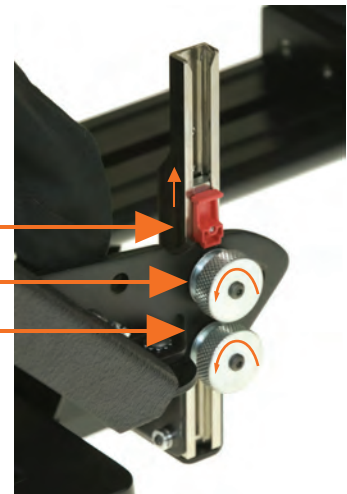

GLASS REMOVAL PROCEDURE

It is not normally necessary to remove the beamsplitter glass from the hood. In certain cases such as breakage or cleaning requirements the glass must be removed. The glass is easily removed by unscrewing the four screws on each side of the mirror assembly. To replace the glass just reverse the procedure.



PROLINE FEATURES

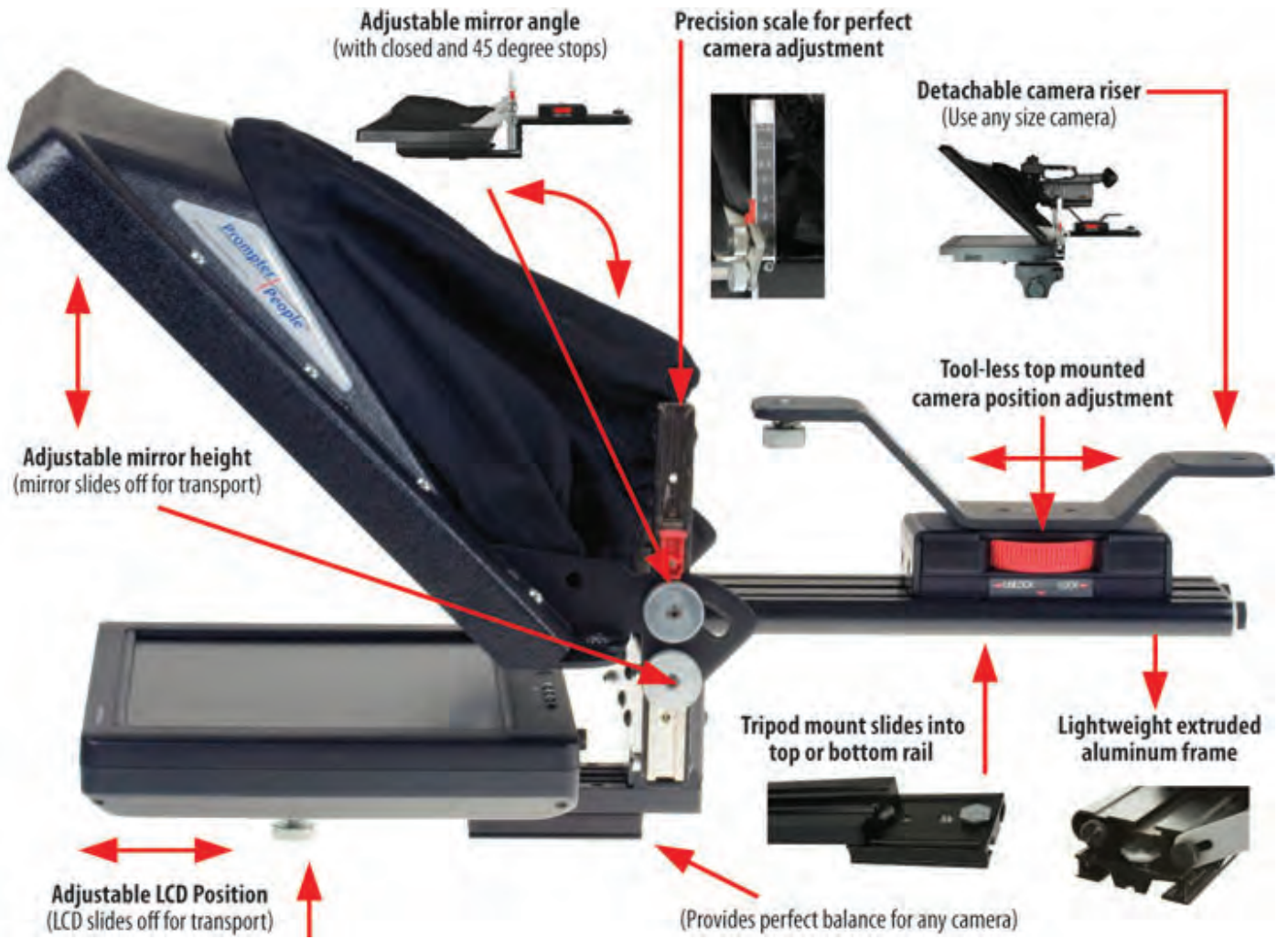

ProLine FreeStand Set-Up Sheet



PROLINE FREESTAND FULLY ASSEMBLED

NOTE: Camera and tripod not provided.

STEP 1 - ATTACH STAND MOUNT TO BRACKET (may be already attached) Screw stand mount into bottom of bracket.



STEP 2 - ATTACH BRACKET TO STAND

The ProLine FreeStand's patent pending mounting system allows the use of any size/weight camera. The FreeStand ships with 2 stands, one short and one tall. Use the short stand if the subject is in a low chair. For normal chair and standing subjects use the taller stand.



Tighten handle after
bracket is set onto stand.

STEP 3 - LCD INSTALL

Slide the LCD monitor onto the rail and
tighten the thumbscrew.

The LCD can be adjusted fore/aft by loosening
the thumbscrew. To remove the LCD unscrew
the thumbscrew all the way and slide the LCD
off the rail.

**Note: The thumbscrew has a stop to keep it
from coming out all the way.**



MIRROR ASSEMBLY/REMOVAL

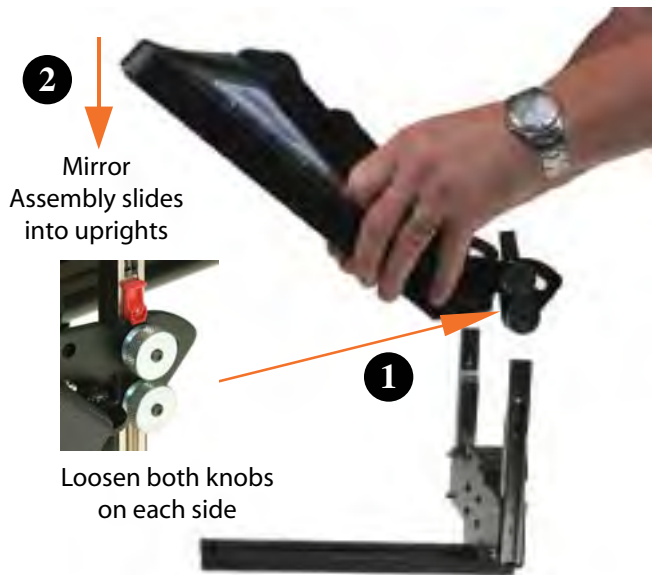

MIRROR ASSEMBLY ATTACHMENT

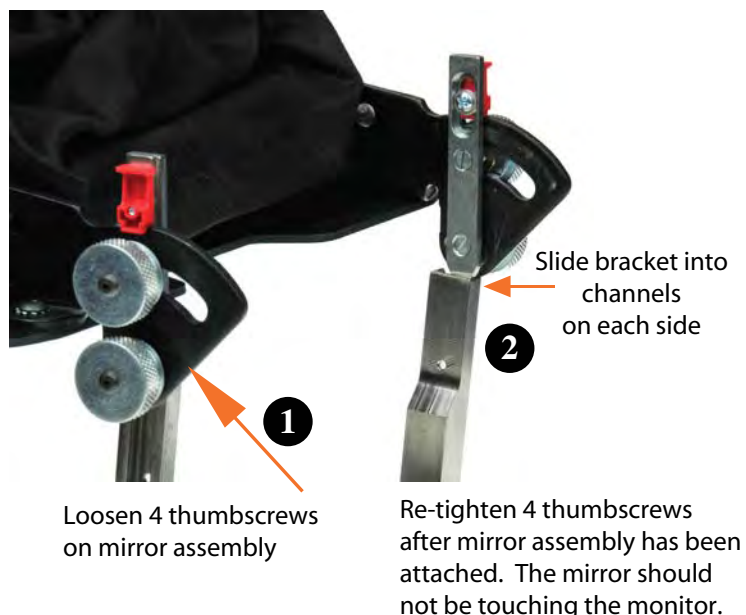

ADJUSTING MIRROR ASSEMBLY

The ProLine FreeStand's patent pending mirror assembly offers both height and angle adjustment. The mirror assembly can also be folded flat for easy, safe transport. The mirror assembly offers an infinitely adjustable angle and locks at the closed and standard 45 degree positions. The mirror assembly can also be easily removed for more compact transport.

OPENING MIRROR ASSEMBLY

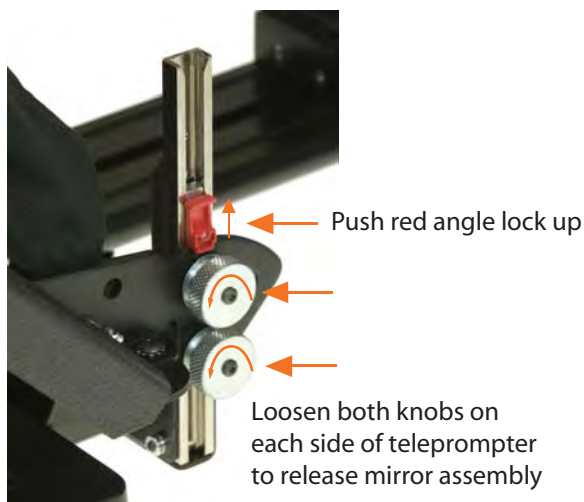

Press down red 45 degree angle locks into notch to lock mirror assembly in position.



Re-tighten knobs.

STEP 4 - CAMERA/LCD POSITION ADJUSTMENT

The Proline FreeStand allows easy set-up and adjustment. The cloth lens shade wraps around the lens to keep light from entering from the rear. The LCD can be positioned fore/aft by loosening its thumbscrew. The LCD can be quickly removed for safe, compact transport. The mirror assembly can also be quickly and easily removed for safe and compact transport.



ADJUSTING MIRROR HEIGHT

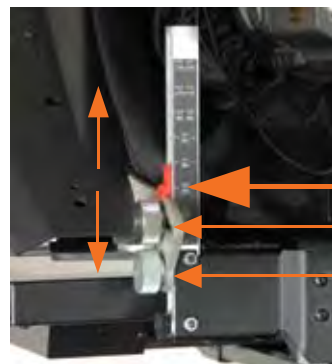

To use height scale position the top of the bracket to the point on the scale that corresponds to your camera's lens height. Measure the lens height from the bottom of the camera. Tighten both knobs on each side to lock mirror height in place

Camera should be positioned so that the lens is in the center of the hood opening. The lens should be within an inch of the beamsplitter. Attach the hood to the lens and tighten up the drawstring so there are no light leaks.

ADJUSTING MIRROR ANGLE



To adjust mirror assembly to an angle other than 45 degrees do the following

1. Lift the angle lock on both sides.
2. *Slightly* loosen the four thumb screws,
3. Adjust angle and tighten knobs to lock

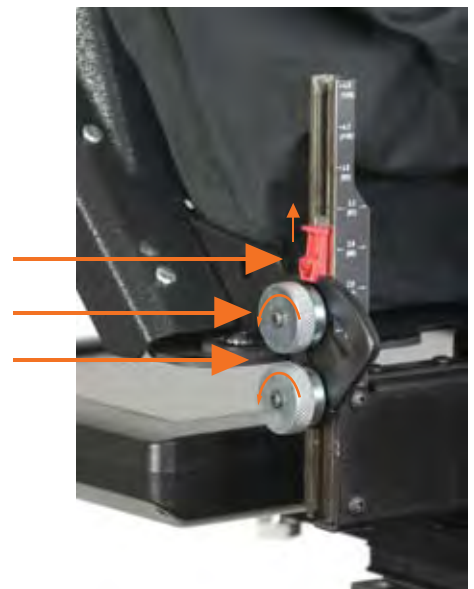

GLASS REMOVAL PROCEDURE

It is not normally necessary to remove the beamsplitter glass from the hood. In certain cases such as breakage or cleaning requirements the glass must be removed. The glass is easily removed by unscrewing the four screws on each side of the mirror assembly. To replace the glass just reverse the procedure.



The ProLine StagePro 15/17/19 Set-Up Guide

1 Connect the monitor arm to the StagePro pole.



2 Tighten down the clamp that attaches the sled to the StagePro pole.



3 Attach monitor arm to StagePro stand with thumbscrew.



4 Attach clamp to stand and secure with screw.



5 Slide Glass into Clamp.



Note: Make sure the aluminum plate on the mirror faces the thumbscrews.



7 Use thumbscrew to tighten angle adjustment. Set to approximately 45 degrees and adjust as necessary to center the image in glass.



Note: Raising the monitor higher on the pole increases the image size and brightness. Use the included skirt to hide wires in the raised position.



ProLine Studio 17 Set-Up Sheet

STEP 1 - ATTACH TRIPOD MOUNTING PLATE

The ProLine Studio 17's patent pending mounting system allows the use of any size/weight camera. This mounting system allows the tripod mounting plate to be attached to either the upper rail or lower rail of the teleprompter. For heavier cameras mounting the tripod plate to the upper rail has the added benefit of lowering the center of gravity for improved tripod head operation. In addition, the tripod mounting plate can slide anywhere along the rails for precise balancing.



For lighter cameras the tripod mounting plate is attached to the lower rail.



For heavier cameras the tripod mounting plate is attached to the upper rail.



Tripod plate slides into channel on either upper or lower rail.

Loosen thumbscrews and lift up retaining plate on back of upper rail to slide on tripod mounting plate.

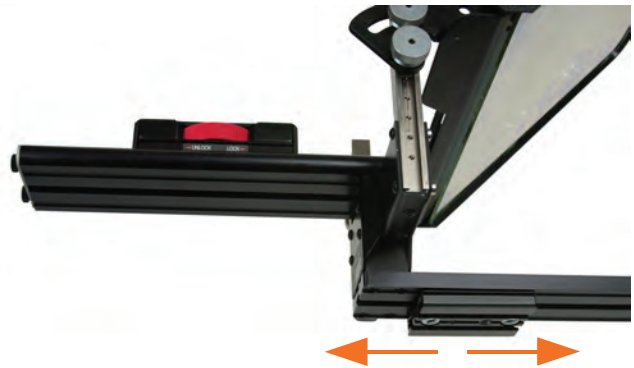
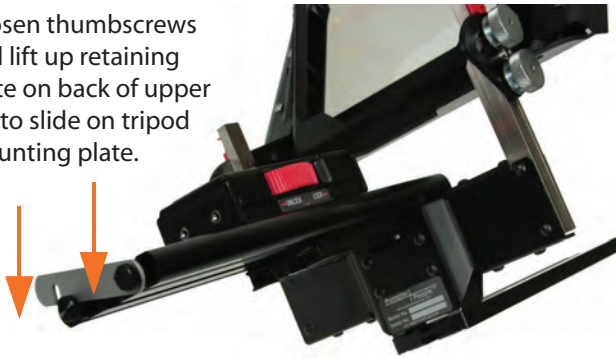

Slide tripod mounting plate front to back to balance teleprompter



Tighten screws to secure tripod plate. Screws can be tightened with a coin or screwdriver.



The tripod mounting plate offers both 1/4" and 3/8" industry standard mounting holes. Attach this plate to your tripod's quick release plate.

STEP 2 - LCD INSTALL

Slide the LCD monitor onto the lower rail and tighten the thumbscrew.

The LCD can be adjusted fore/aft by loosening the thumbscrew. To remove the LCD unscrew the thumbscrew all the way and slide the LCD off the rail.

Note: The thumbscrew has a stop to keep it from coming out all the way.

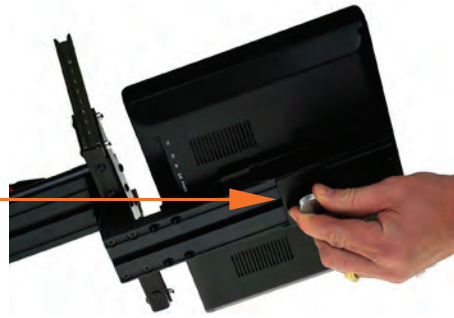

MIRROR ASSEMBLY REMOVAL

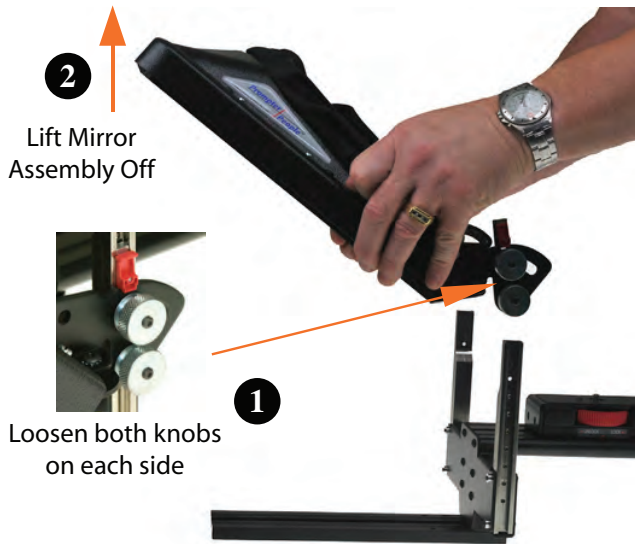

2

Lift Mirror Assembly Off

1

Loosen both knobs on each side

MIRROR ASSEMBLY ATTACHMENT



Slide bracket into channels on each side

2

1

Loosen 4 thumbscrews on mirror assembly

ADJUSTING MIRROR ASSEMBLY

The ProLine Studio 17's patent pending mirror assembly offers both height and angle adjustment. The mirror assembly can also be folded flat for easy, safe transport. The mirror assembly offers an infinitely adjustable angle and locks at the closed and standard 45 degree positions. The mirror assembly can also be easily removed for more compact transport.

OPENING MIRROR ASSEMBLY

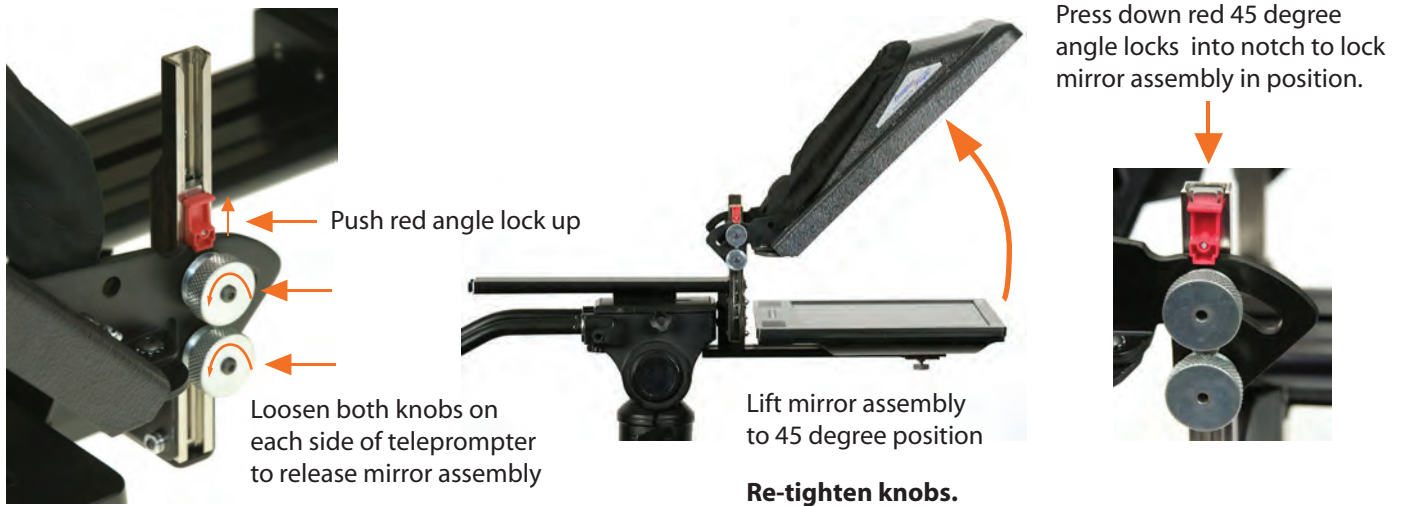

Push red angle lock up

Loosen both knobs on each side of teleprompter to release mirror assembly

Lift mirror assembly to 45 degree position

Re-tighten knobs.

Press down red 45 degree angle locks into notch to lock mirror assembly in position.

STEP 3 - ATTACH CAMERA TO TELEPROMPTER

The ProLine Studio 17 offers multiple methods for attaching your video camera. Larger cameras attach directly to the camera mounting block. Smaller cameras mount on the included dual height camera riser that attaches to the camera mounting block. The dual height camera riser also allows cameras with short or flush mounted lenses to get closer to the teleprompter mirror for optimum performance.

The ProLine Studio 17 has a height scale on the mirror assembly. To use this scale measure the center of the camera lens from the bottom of the camera.

MEASURE LENS HEIGHT

Measure from the bottom of the camera to the center of the lens. This is your camera lens height. Write down this number. You will use this number to adjust the mirror height. in a later step.



PLACE CAMERA ON SLED

Place camera on camera mounting block.



The spring loaded pin locks into camera hole to keep camera from rotating. Rotate camera until this locks in place.

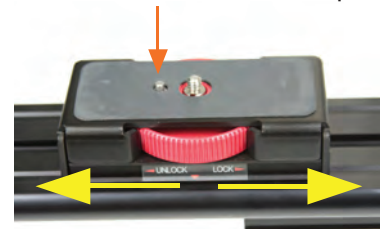

Turn the camera knob to secure camera. Loosen slightly to adjust camera position. When camera is in position turn knob to lock into place. Do not over tighten.



The camera thumbscrew can be removed from one end and attached to the other side.

USING DUAL HEIGHT RISER

The dual height camera riser is used with smaller cameras. To attach simply place riser on camera mounting block and tighten the camera block knob. Loosen slightly to adjust camera position.

NOTE: Full sized cameras do not require dual height riser.



Example of palm camcorder with riser block.

STEP 4 - CAMERA/LCD POSITION ADJUSTMENT

The ProLine Studio 17's top mounted camera block makes fore/aft camera positioning a fast, tool-free procedure. Remove the lens shade on your camera so that the lens can get as close to the glass as possible. Then simply turn the large red, knurled knob to tighten or release the camera for easy adjustment. The cloth lens shade wraps around the lens to keep light from entering from the rear. The 10.4" LCD can be positioned fore/aft by loosening it's thumbscrew. The LCD can be quickly removed for safe, compact transport. The mirror assembly can also be quickly removed for safe and compact transport.



Turn knob to left to unlock and to the right to lock. Remove the cameras lens shade. Position camera lens within 1/2" from glass.



Once camera is positioned place lens shade around lens. Tighten lens shade with draw string.

ADJUSTING MIRROR HEIGHT



Raise the mirror assembly so that the camera lens is in the middle of the mirror.

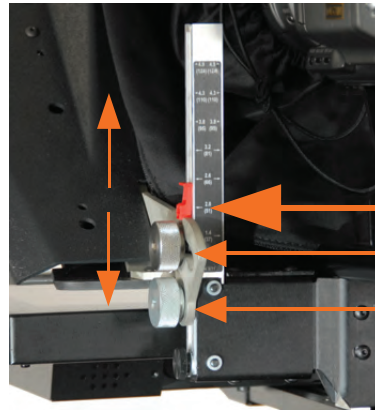

To use height scale position the top of the bracket to the point on the scale that corresponds to your cameras lens height. Measure the lens height from the bottom of the camera.

Tighten both knobs on each side to lock mirror height in place



ADJUSTING MIRROR ANGLE

To adjust mirror assembly to an angle other than 45 degrees do the following

1. Lift the angle lock on both sides.
2. **Slightly** loosen the four thumb screws,
3. Adjust angle and tighten knobs to lock

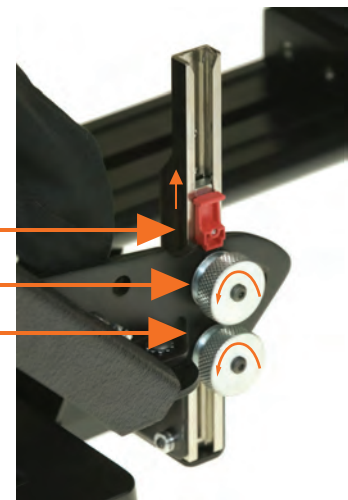

GLASS REMOVAL PROCEDURE

It is not normally necessary to remove the beamsplitter glass from the hood. In certain cases such as breakage or cleaning requirements the glass must be removed. The glass is easily removed by unscrewing the four screws on each side of the mirror assembly. To replace the glass just reverse the procedure.



PROLINE FEATURES

